

ACE MENTOR PROGRAM OF RHODE ISLAND

2022 KICKOFF NEWSLETTER

www.acementorri.org



ACE MENTOR PROGRAM
ARCHITECTURE • CONSTRUCTION • ENGINEERING

RHODE ISLAND



MESSAGE FROM CHAIR PG 3

MET IN-SCHOOL PROGRAM PG 4

1ST YEAR PROGRAM PG 6

ADVANCED PROGRAM PG 8

FUNDRAISING PG 10

MENTORS PG 11

GET INVOLVED PG 12

SUPPORTERS PG 14



MESSAGE FROM ACE RI CHAIRMAN LANCE ALEKSIEWICZ

Happy New Year!

The ACE Mentor Program of Rhode Island (ACE RI) kicked off the 2021-2022 program year with four different groups of students meeting at various times and days of the week, which is wonderful. Even during these difficult times, our volunteer mentors, committee members, and board members found the time to pull together resources, plan, and implement curriculums for each group. Amazing! I couldn't be more proud of our volunteers and the sponsor firms that encourage them to participate. Check out what they've been up to in this newsletter.

I am also happy to announce that ACE RI has joined the United Way of Rhode Island's Afterschool Network (RIAN). We have been searching for partnerships to strengthen the program and we are looking forward to capitalizing on the opportunities that RIAN offers to local nonprofits. Joining RIAN paid immediate dividends as we were able to apply for a \$15,000 mini grant being offered in December, which we were awarded! With this grant ACE RI is hoping to hire a part-time staff member to help grow the program so even more high school students in RI can reap the benefits.

The board of directors had been discussing hiring a part-time employee for the past few years. We were so excited to receive the grant because it will help cover the cost of hiring the staff member we so desperately need. Now the search for a part-time Administrative Assistant / Director of Operations begins! We are looking for someone with a passion to work for a non-profit organization with our mission and goals.

Finally, I cannot end without thanking all of our sponsors, volunteers, schools, and the students and their families. Together we all make ACE RI a possibility and provide a bright, inclusive future for the design and construction industry. Let's keep it going!



A handwritten signature of Lance Aleksiewicz in black ink.

Lance Aleksiewicz
Chairman, ACE RI
Associate Principal, Odeh Engineers



MET IN-SCHOOL PROGRAM

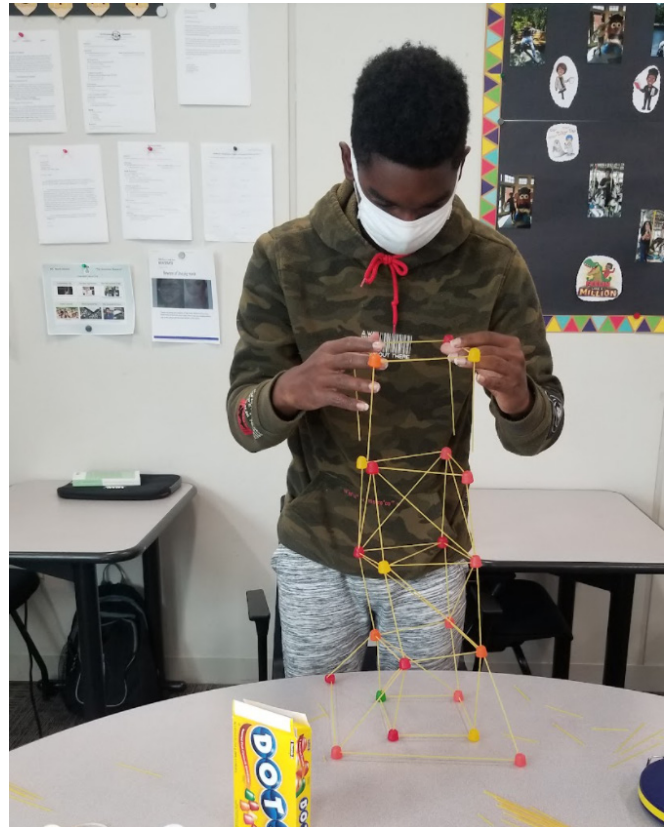

ACE kicked off programming at the Met in September with a Career Awareness activity with sixteen 9th grade students in Siobhan O'Malley's classroom. Mentors "Zoomed" in while students learned about ACE careers, had a brainstorming competition about how many different jobs it takes to construct a building, and then competed in teams to build the tallest structure using gumdrops and pasta. It was a fun way for students to learn about the ACE fields and all of the jobs connected to the industry. It was so beneficial, we plan on repeating the activity with other 9th grade classrooms in the future.

From October to January, a core group of six 10th through 12th grade students participated in a virtual first year ACE program. Mentors "Zoomed" in while students were in their individual classrooms at the Met on Thursday afternoons. Students kicked off the program with the traditional Gum Drop Pasta Challenge. The following weeks students completed measuring and scale activities, learned how to complete 3D drawings on their Chrome books in Sketch-up, and finished by drawing a barn in Sketch-up. Since it is challenging to get

to know the students when the programming is virtual, one-on-one get to know you sessions were scheduled with each student which helped the mentors better understand each student's interests and goals for the program.

Student finished the program in January, and completed the visitors center design project. Their teamwork shined through as they came together and presented their final projects to their mentors. The MET is extremely appreciative of the mentors hard work and dedication throughout the program.

ACE Mentors in the MET Program

Rebecca Fletcher
Wayne St. Vincent
Fide Lamour
Amine Ghanem
Samantha Denton
Scott Illingworth
Victoria Howland

Vision 3 Architects
VHB
RWU
RWU
Pariseault Builders
Pariseault Builders
Pare Corporation

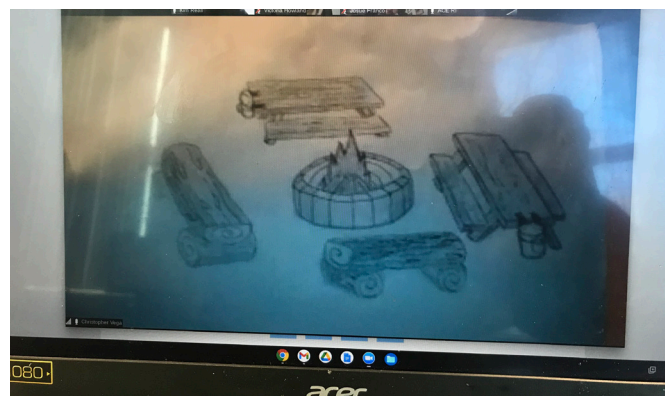
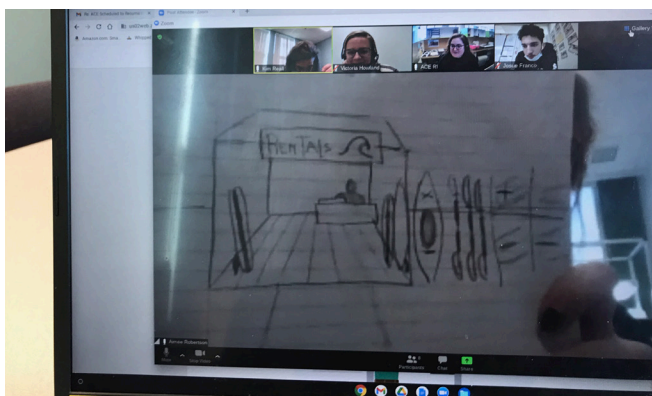
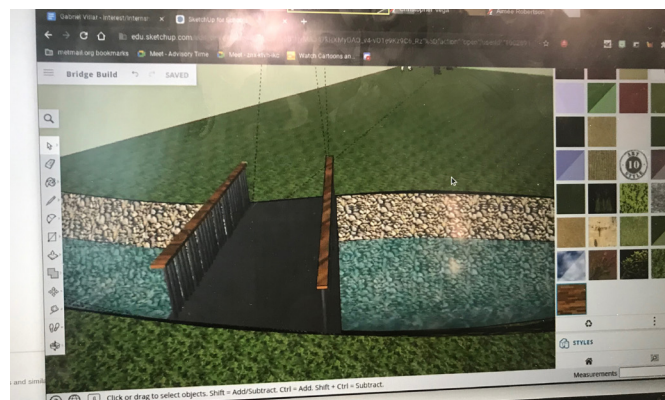
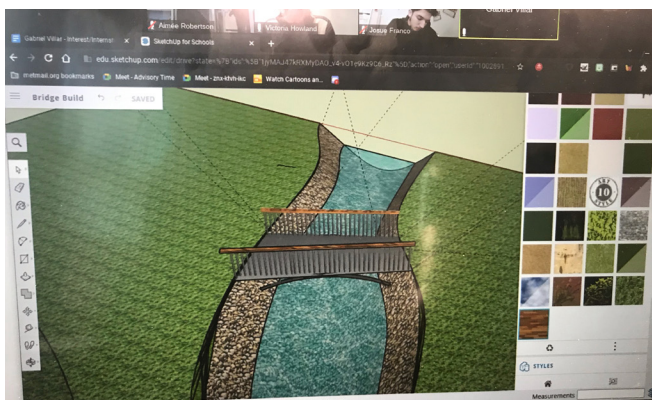
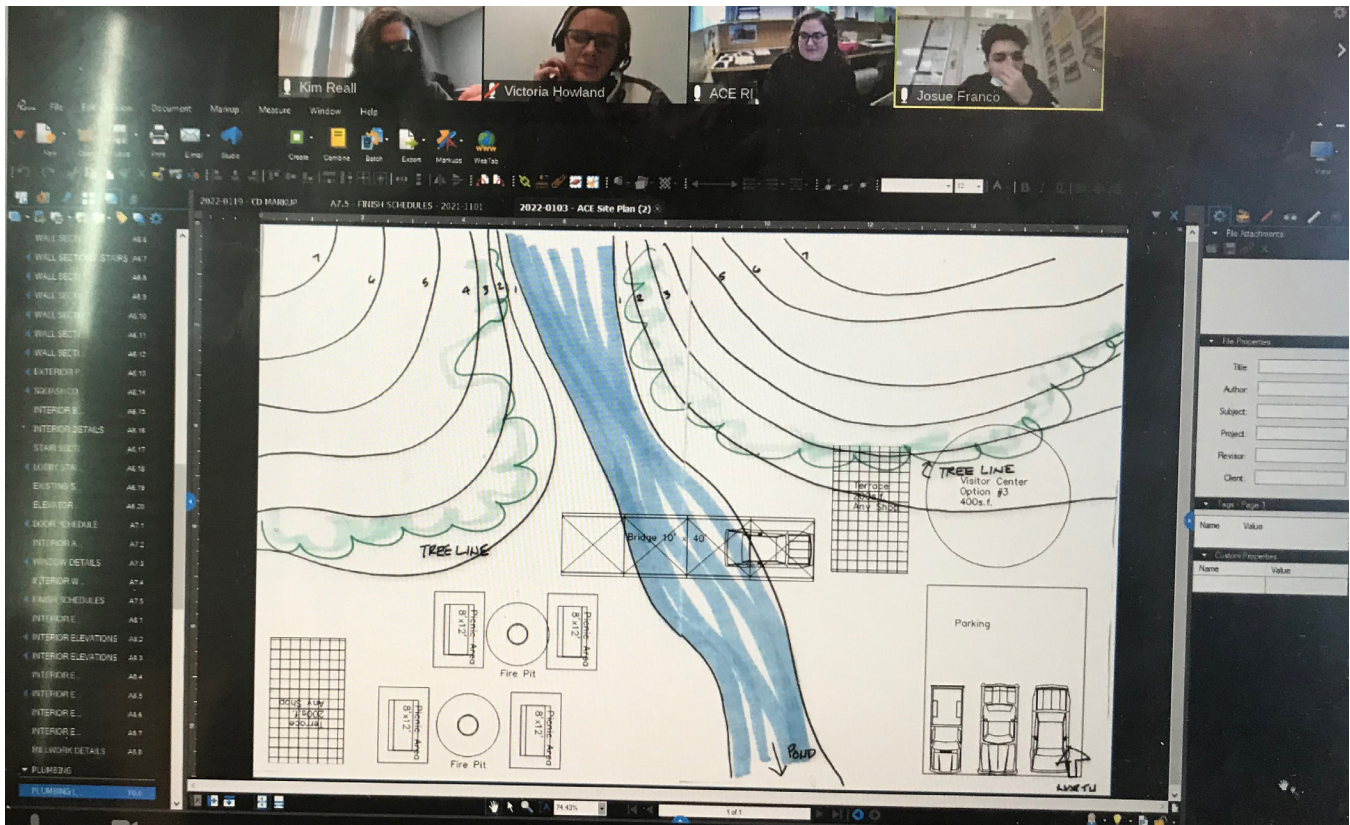



FIRST YEAR PROGRAM

During the fall session, 25+ students from Woonsocket to Westerly and all areas in between participated in our virtual meetings. Over 11 weeks a variety of mentoring activities introduced the students to the basics of each ACE discipline and practiced skills relevant across the building industry. Kits containing tools and support materials were mailed directly to students' homes.

Despite the virtual setting, activities were not limited to interacting with a computer screen. Activities were developed to take advantage of students' surroundings. They included practicing measuring and drawing plans to scale, building structures like towers and bridges, and exploring their neighborhoods through the eyes of an ACE professional.

Moving into the winter session, the program focuses on the design of a "sustainable visitor center". Over 10 weeks, students apply basic skills learned in the fall session to an ongoing project. By focusing on a single project, the students will be able to explore the individual roles of each discipline and see how each of the ACE roles collaborate with each other. The winter session kicked off on Tuesday, January 11th. The sessions will then run weekly on Tuesdays from 4:00pm-5:15pm.

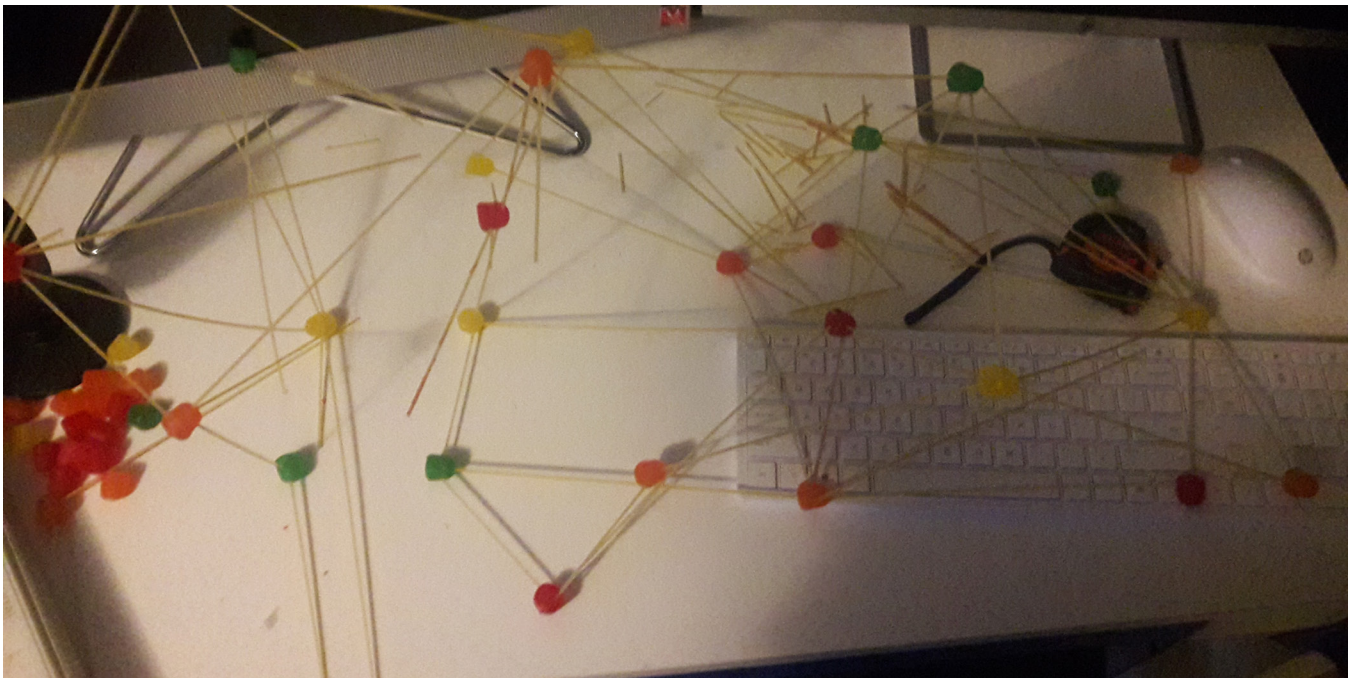
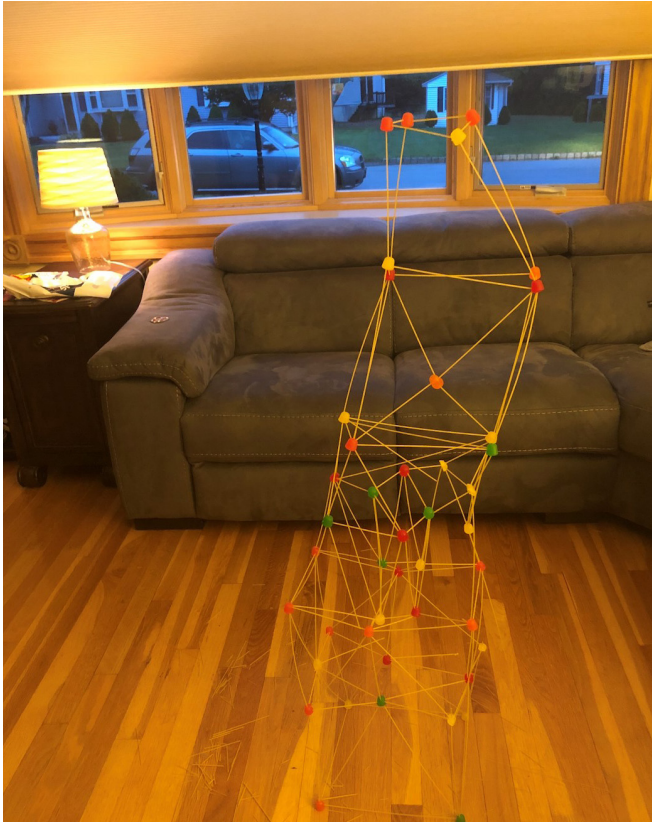



ADVANCED PROGRAM

The ACE-RI advanced student program continues with more students participating than any prior year. Currently 15 students and 10 mentors are meeting weekly via ZOOM. Attendance has been consistent since mid-October for the 4:00-5:30pm Thursday sessions.

Students are working on the annual ACE-CIRT National Design Competition with submissions due on March 16, 2022. Two teams were created based on student interests. Each team is working on one a different project selected from the options offered in the Competition.

Urban Renewal: Students have selected to pursue the design of a new MBTA train station at the site of the abandoned station in Pawtucket. The site will include housing, a commercial greenhouse, community gardens, as well as a CVS and a Co-op grocery store modeled after Urban Greens in Providence. Below are some images from recent student work.

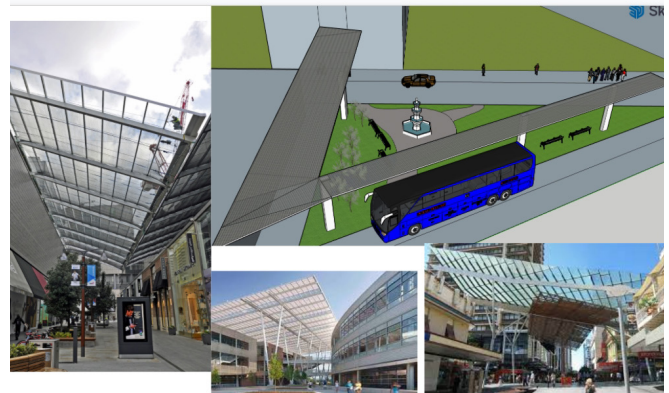

Joe- South Housing



Adrienne -- Community Gardens



ACE Mentors in the Advanced Program

- Rebecca Fletcher, Vision 3 Architects
- Kelly Price, Odeh Engineers
- Andrew Larsen, Vision 3 Architects
- Michael Sumner, Union Studio
- Joe Raposo, Site Specific
- Maris Smith, RISD PM
- Erin Ball, Odeh Engineers
- Gabriella Caron, Gilbane
- James Barnes, RISD Emeritas
- Tami Hughes, DBVW
- Alec Kalogeropoulos, B-CM RWU
- Peter DiSpigno, Trinity Engineering
- Melissa Whereley
- Alex Mendoza, Gilbane
- Liam Hulihan, MArch RWU
- Jack Quinn, Gilbane
- Elena Pascarella, Landscape Elements
- Scott Ilingworth, Pariseault Construction

Adriana: Train Station and Approaches



Memorial of the Future: Students have chosen to pursue a memorial for indigenous people that will be built at Ninigret Park in Charlestown RI. We visited the Tomaquag Museum and were inspired by the basket weaving patterns, stone cairns and the belief in honoring the ancestors but paving the path for the future seven generations. The memorial will be a modernized wingwam or longhouse using modern materials that will be long lasting. There will be two path that will allow different experiences which will include colors, symbols, stone cairns and basket weaving patters to be seen along the path. The idea of the seven generations will also be honored in the design.

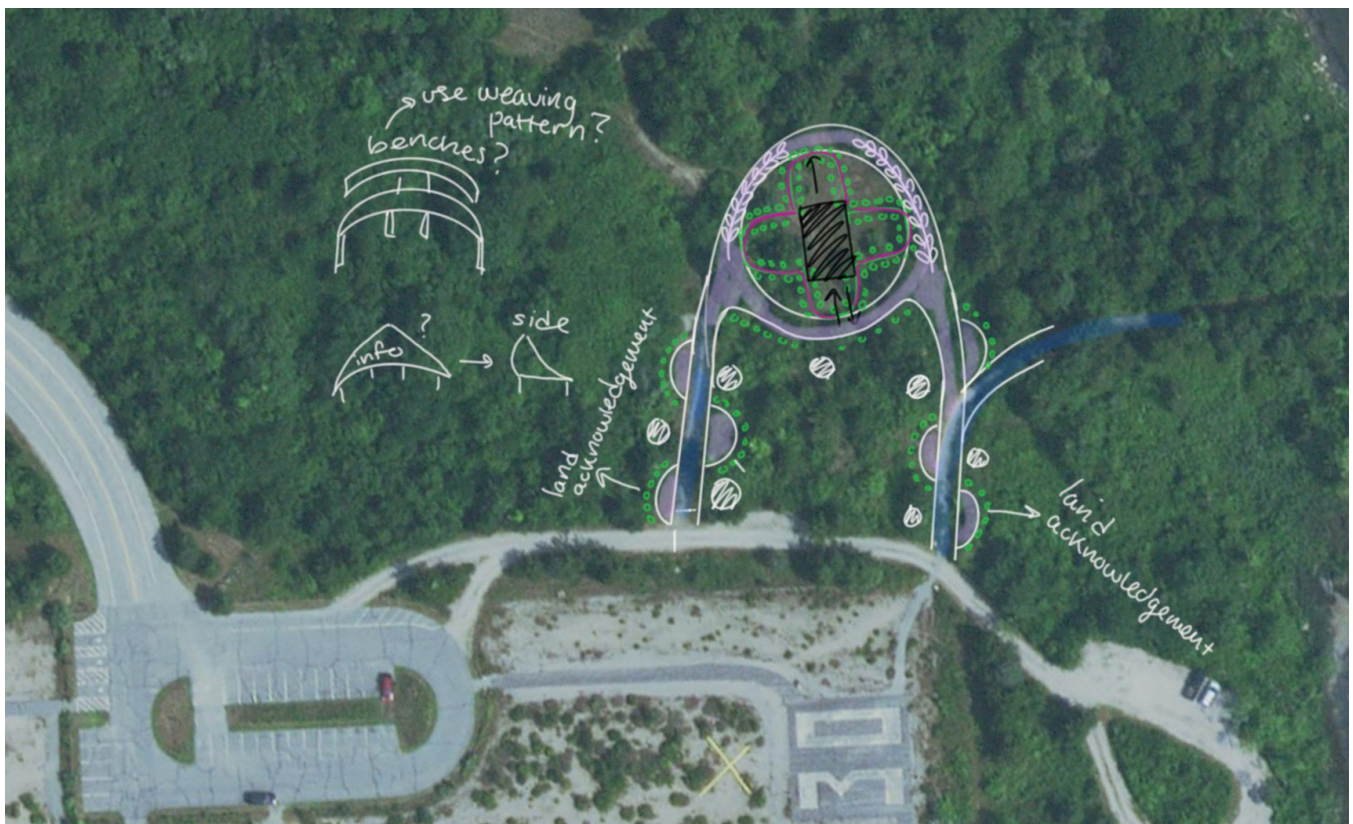



FUNDRAISING

\$31,175

Raised in 2021

\$50,000

2022 Goal

In 2021 we received \$31,175 in donations. This was due to a great effort by our Advisory Board, Committee Volunteers, and especially our donors. We are grateful for all the effort and generosity.

These funds were raised primarily from two drives. First, our Annual Fundraising Breakfast. The breakfast was responsible for over \$22,000 of the funds raised through in-person attendance and our sponsor firms. 2021 saw our first increase in sponsorship levels in many years, but those sponsorships included increased marketing for the sponsor firms. ACE RI provides mentions and logo placement for sponsor firms in our marketing materials and on social media, along with speaking opportunities and free tickets to our fundraising events.

The second drive, new to us in 2021, was the 401Gives charity event. This online event lasted only a few days, with a giving “frenzy” on April 1. This event is for the non-profit organizations in RI and is hosted by the United Way and GiveGab.com. We set a goal to raise \$10,000 during this event and were able to reach \$5,245. Although we didn't

get to our goal, we still consider this event a success. We are very thankful for the 70+ donations we received in just a few days. The remainder of the money raised was achieved through individual PayPal and direct check donations sent to ACE RI.

Again, thank you to those donors. Every dollar helps. We have planned our 2022 fundraising efforts and will continue the Annual Breakfast tradition this spring. We will also participate in the 401Gives Campaign again this year. Be on the lookout for our announcements about these events as they get closer.

This year, our fundraising goal is to raise \$50,000 to provide scholarships, training supplies, and food and beverage to our students. We appreciate all that you do to help us accomplish this goal.



ACE RI IS LOOKING FOR VOLUNTEERS.

A small number of ACE RI Professionals organize and run a very effective program for RI High School students each year. We are always in need of new faces to maintain and nurture this effective program. ACE RI is seeking professionals of all levels who can join this important work, including mentoring, assisting with program development, and fundraising.

Schools currently represented in the ACE-RI Program

- Barrington High School
- Blackstone Academy Charter School, Pawtucket
- Chariho Regional High School
- LaSalle Academy
- Lincoln High School
- The Met School
- North Providence High School
- North Smithfield High School
- Smithfield High School
- Providence Career and Technical Academy
- Somerset Berkeley Regional High School
- St. Andrews School
- St. Mary-Bayview Academy
- Woonsocket High School
- Westerly High School



GET INVOLVED WITH ACE RI

Interested in joining ACE RI as a
Board Member, Committee Member,
Mentor or School Liaison?

Email info@acementorri.org

21-22 BOARD OF DIRECTORS



Lance Aleksiewicz
Chairman

Odeh Engineers
Associate Principal



Chris Jasinski
Vice-Chairman

Brick
Director of Marketing



Jim Barnes
Secretary

RISD
Professor Emeritus



Treasurer



Erik Sanford
Fundraising Chair

Dimeo Construction Com-
pany - VDC/BIM Director



Larry Trim
Student Recruitment Chair

Kaestle Boos Assoc. Inc.
Principal



Greg Laramie, AIA
Governance Chair

Roger Williams University
Associate Dean



Tami Hughes
Advanced Program Director

DBVW
Associate



Kim Reall
Board Member

The Met School
Mgr of Partnerships and
Certifications



Katie Strumolo
Board Member

Gilbane
Sr. Preconstruction
Executive



Kara Cady
Board Member

MA-AGC
Operations Manager



Siobhan O'Malley
Board Member

The Met School



2021-22 ACE RI PARTNERS

Keystone Partners



RHODE ISLAND
CHAPTER



Cornerstone Partners



Foundation Partners

SITE SPECIFIC



STRUCTURES WORKSHOP

LLB ARCHITECTS

Firm Partners

Saccoccio & Associates
Titan Roofing
Trinity Engineering
Wilkinson Associates





2022 PARTNERSHIP LEVELS

Keystone Partner - \$3,000

These generous partners enable Rhode Island students to pursue the interests in the A/C/E fields. We greatly appreciate your support and will feature your company throughout the year on ACE RI material.

INCLUDES:

- Company logo with link to company website prominently displayed on ACE RI website
- Continuous logo placement on website, in newsletters and at live events
- 8 tickets to the fundraiser breakfast
- 4 social media posts
- 2 ACE RI newsletter features
- 2 speaking opportunities at weekly meeting for students and mentors



Cornerstone Partner - \$1,500

Our cornerstone partners support are vital to our yearly programming and scholarships. We greatly appreciate your commitment to ACE RI!

INCLUDES:

- Continuous logo placement on website, in newsletters and at live events
- 4 tickets to the fundraiser breakfast
- 4 social media posts
- 1 ACE RI Newsletter Features
- 1 speaking opportunity at weekly meeting for students and mentors



2022 PARTNERSHIP LEVELS



Foundation Partner - \$750

Our foundation partners support is crucial to developing programming every year.

INCLUDES:

- Continuous logo placement on website, newsletter, and at live events
- 2 tickets to the fundraiser breakfast
- 2 social media posts



Firm Partner - \$350

Our firm partners donations add up to larger efforts for ACE RI. We greatly appreciate your support!

INCLUDES:

- Company name listed on support page of ACE RI website
- 1 Ticket to the fundraiser breakfast





ACE MENTOR PROGRAM
ARCHITECTURE • CONSTRUCTION • ENGINEERING

RHODE ISLAND

www.acementorri.org

FOLLOW US:
[@ACEMentorRI](#)

